



ViewPAC

Features

- 7", 8.4", 10.4", 12.1" and 15" TFT LCD
- Cortex-A8 720 MHz/1 GHz CPU
- CE7 (Windows Embedded Compact 7)
- Hard Real-Time Capability
- Support eLogger HMI (free)
- PoE (Power over Ethernet)
- NEMA 4/IP65 Compliant Front Panel
- Ultra-Rugged Construction and Reliable Design
- Operating Temperature: -10 °C to +60 °C



Introduction

The VP-x201-CE7 are CE7 based ViewPACs that combine computing, I/O, and operator interface into a single unit, and provide the perfect solution for integrating HMI, data acquisition and control in an individual PAC. It is equipped with an Cortex-A8 CPU, TFT LCD and a variety of connectives including dual Gigabit Ethernet, USB port, RS-232 and RS-485 interface. I/O expansion is available to use our Ethernet I/O modules and RS-485 I/O modules. Designed for panel mount installation, the front panel is NEMA 4/IP65 rated and can withstand sprayed water, humidity and extreme dust. Designed to operate over a wide -10°C to 60°C ambient temperature range, the fanless design offers the ultimate in reliability with no moving parts.

Windows Embedded Compact 7 is a componentized, hard real-time, high performance, and highly reliable operating system. CE7 delivers rich user experiences and a unique connection to Windows PCs, servers, services, and devices.

Windows Embedded Compact 7

CE7 is a compact and hard real-time OS used to quickly create time critical and high performance applications. Using CE7 gives an ability to run PC-based control software such as Visual Basic .NET, Visual C#, SCADA software, SoftPLC... etc.



- FTP Server
- Web Server
- SQL Compact Edition 3.5
- .NET Compact Framework 3.5
- Virtual CE Pro (VCEP)
- OPC Server (NAPOPC DA Server)
- Soft PLC solution ISaGRAF inside
- SCADA solution InduSoft inside

Specifications

| Models | VP-2201-CE7 | VP-3201-CE7 | VP-4201-CE7 | VP-5201-CE7 | VP-6201-CE7 |
|---------------------------------|---|---|--|----------------|----------------|
| LCD | | | | | |
| Diagonal Size | 7" (16:9) | 8.4" (4:3) | 10.4" (4:3) | 12.1" (4:3) | 15" (4:3) |
| Resolution | 800 x 480 | 800 x 600 | | | 1024 x 768 |
| Brightness (cd/m2) | 400 | | | | |
| Contrast Ratio | 500 : 1 | | | | |
| LED Backlight Life (hrs) | 20,000 | 50,000 | | | |
| Touch Panel | 4-wire, resistive type; light transmission: 80 % | 5-wire, resistive type; light transmission: 80 % | | | |
| System Software | | | | | |
| OS | Microsoft Windows Embedded Compact 7 | | | | |
| Framework Support | .NET Compact Framework 3.5 | | | | |
| Embedded Service | FTP server, Web server (supports VB script, JAVA script), SQL Compact Edition 3.5 | | | | |
| SDK Provided | DII for Visual Studio.Net | | | | |
| Multilanguage Support | English, German, French, Spanish, Portuguese, Russian, Italian, Korean, Simplified Chinese, Traditional Chinese | | | | |
| CPU Module | | | | | |
| CPU | Cortex-A8, 720 MHz | Cortex-A9, 1 GHz | | | |
| SDRAM | 512 MB (DDR3) | | | | |
| MRAM | 128 KB | | | | |
| Flash (SSD) | 256 MB | | | | |
| EEPROM | 16 KB | | | | |
| Memory Expansion | microSD socket with a 4 GB micro SDHC card (support up to 32 GB) | SD socket with a 4 GB SDHC card (support up to 32 GB) | | | |
| RTC (Real Time Clock) | Provide second, minute, hour, date, day of week, month, year | | | | |
| 64-bit Hardware Serial Number | Yes, for software copy protection | | | | |
| Dual Watchdog Timers | 0.8 second | | | | |
| LED Indicator | 2 (Run, PWR) | | | | |
| Rotary Switch | 0 to 9 | | | | |
| Communication Ports | | | | | |
| Ethernet | 1 x RJ-45 10/100/1000 Base-TX | | | | |
| USB 2.0 | 2 | | | | |
| COM 1 | RS-232/RS-485; 2500 VDC isolated | - | RS-232/RS-485 (DB9 connector); 2500 VDC isolated | | |
| COM 2 | RS-232/RS-485; 2500 VDC isolated | | | | |
| COM 3 | - | S-485; 2500 VDC isolated | | | |
| Audio | Earphone-out | | | | |
| Mechanical | | | | | |
| Dimension (W x H x D), Unit: mm | 213 x 148 x 44 | 249 x 207 x 64 | 291 x 229 x 54 | 324 x 255 x 64 | 381 x 305 x 63 |
| Panel Cut-Out (W x H), Unit: mm | 197 x 133, ± 1 | 235 x 193, ± 1 | 277 x 215, ± 1 | 310 x 241, ± 1 | 362 x 286, ± 1 |
| Installation | Panel Mounting, VESA (75 x 75) Mounting | | | | |
| Ingress Protection | Front panel: NEMA 4/IP65 | | | | |
| Environmental | | | | | |
| Operating Temperature | -10 °C to +60 °C | | | | |
| Storage Temperature | -20 °C to +70 °C | | | | |
| Ambient Relative Humidity | 10 % ~ 90 % RH (non-condensing) | | | | |
| Power | | | | | |
| Input Range | +12 VDC to +48 VDC | | | | |
| Power from PoE | IEEE 802.3af | | | | |
| Isolation | - | 1 kV | | | |
| Consumption | 6 W | 7.5 W | 13 W | 14 W | 16 W |

Dimensions

VP-2201-CE7

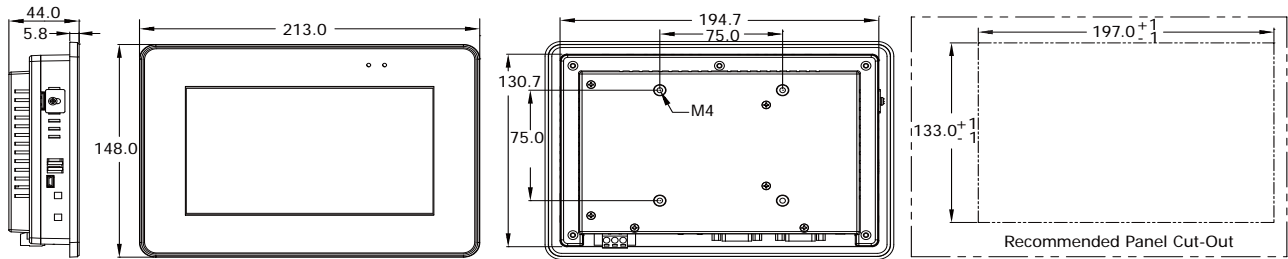

VP-3201-CE7

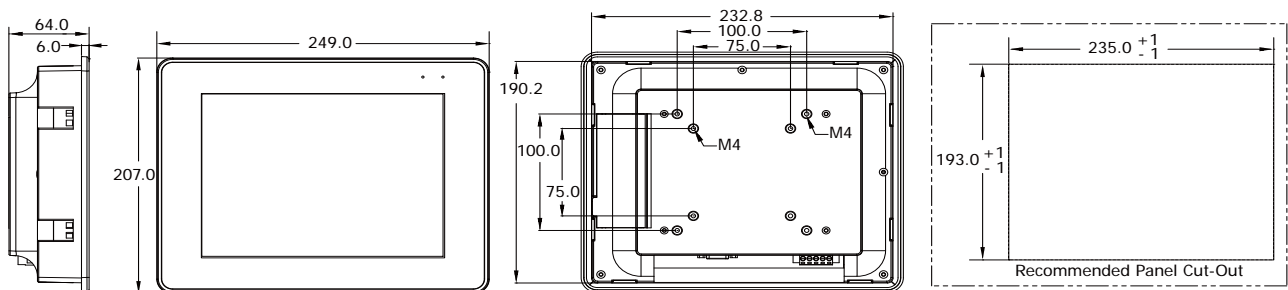

VP-4201-CE7

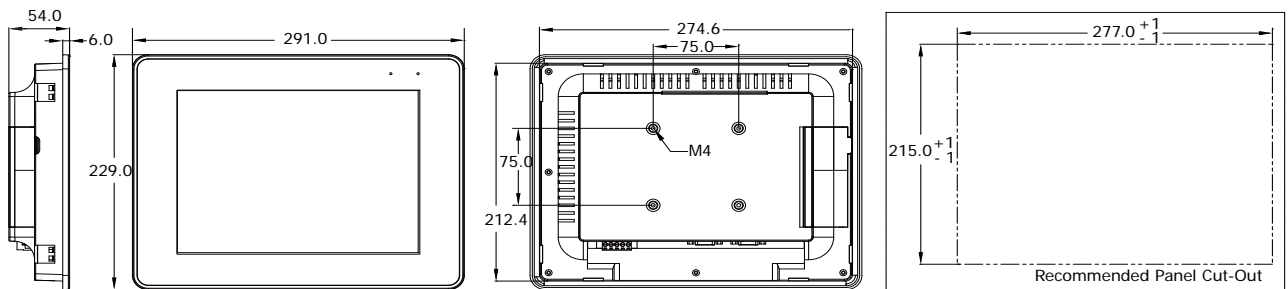

VP-5201-CE7

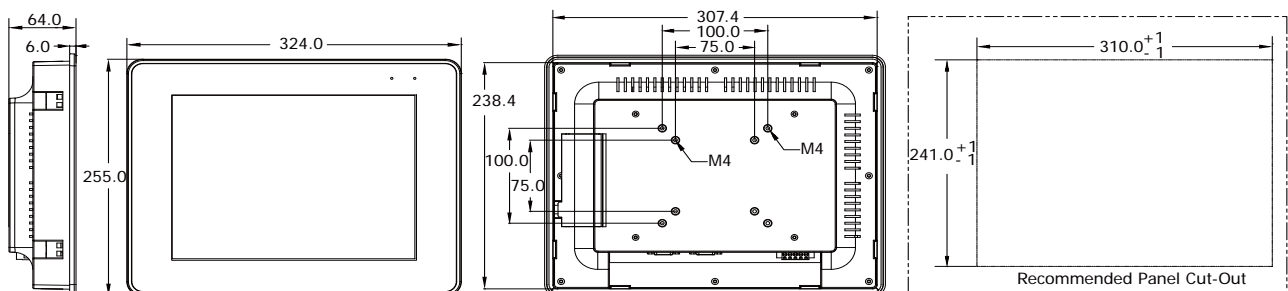

VP-6201-CE7

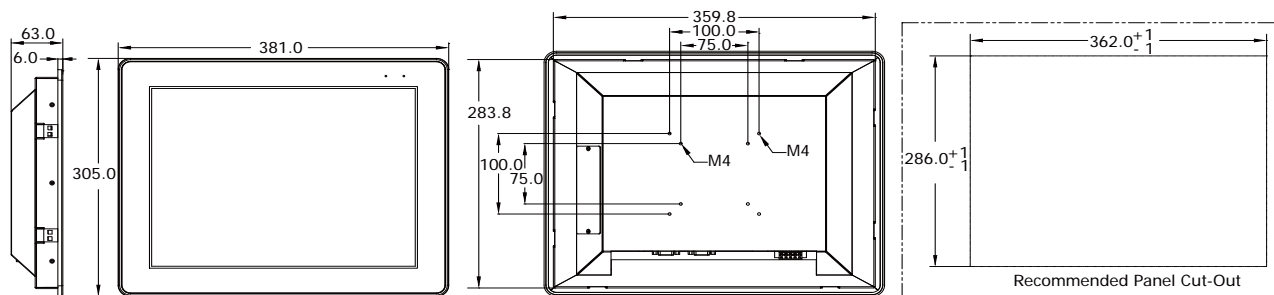

Appearance

VP-2201-CE7

microSD Socket



Rotary SW.

7" LCD Touch Panel

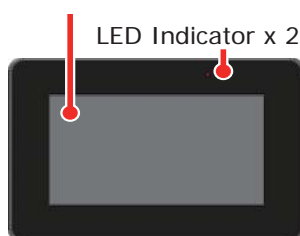

LED Indicator x 2

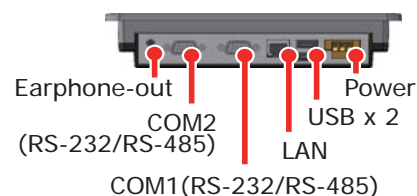

Earphone-out

COM2
(RS-232/RS-485)

Power

USB x 2

LAN

COM1(RS-232/RS-485)

VP-3201-CE7

8.4" LCD Touch Panel

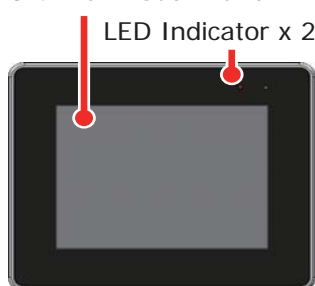

LED Indicator x 2

Console Port



SD Socket

DIP SW.

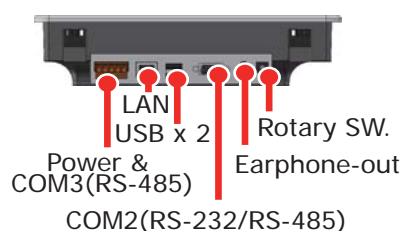

LAN

USB x 2

Rotary SW.

Earphone-out

Power &
COM3(RS-485)

COM2(RS-232/RS-485)

VP-4201-CE7

SD Socket

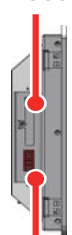

DIP SW.

10" LCD Touch Panel

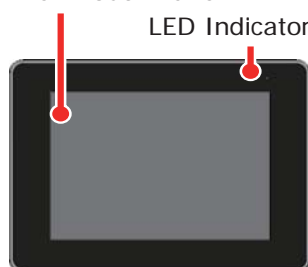

LED Indicator x 2

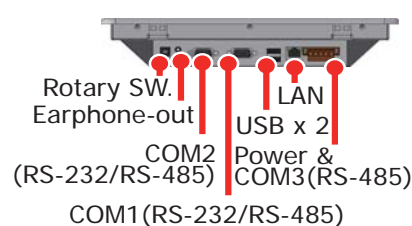

Rotary SW.

Earphone-out

COM2
(RS-232/RS-485)

LAN

USB x 2

Power &
COM3(RS-485)

COM1(RS-232/RS-485)

VP-5201-CE7

12.1" LCD Touch Panel
LED Indicator x 2

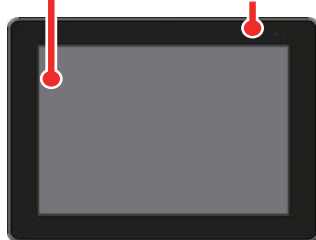

DIP Switch



SD Socket

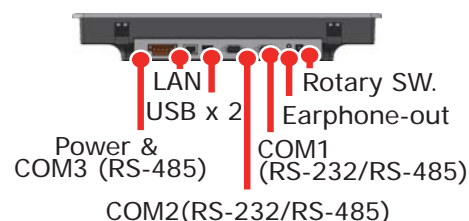

VP-6201-CE7

15" LCD Touch Panel
LED Indicator x 2



DIP Switch



SD Socket

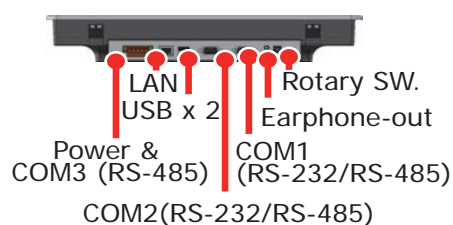

Application

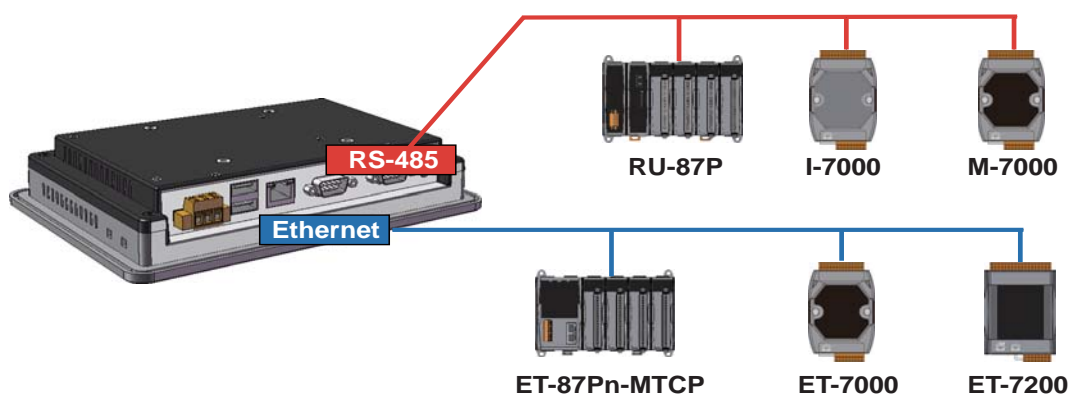

Ordering Information

| | |
|-------------|--|
| VP-2201-CE7 | Standard 7" ViewPAC with Cortex-A8 CPU and CE7 OS |
| VP-3201-CE7 | Standard 8.4" ViewPAC with Cortex-A8 CPU and CE7 OS |
| VP-4201-CE7 | Standard 10.4" ViewPAC with Cortex-A8 CPU and CE7 OS |
| VP-5201-CE7 | Standard 12.1" ViewPAC with Cortex-A8 CPU and CE7 OS |
| VP-6201-CE7 | Standard 15" ViewPAC with Cortex-A8 CPU and CE7 OS |

Accessories

| | |
|--------------|---|
| DP-660 | 24 VDC/2.5 A, 60 W and 5 VDC/0.5 A, 2.5 W Power Supply with DIN-Rail Mounting |
| MDR-60-24 CR | 24 VDC/2.5 A, 60 W Power Supply with DIN-Rail Mounting (RoHS) |